

APARTMENT 42

PARK MODERN

Hyde Park, London

3 Bedrooms

Level 4

GROSS INTERNAL AREA 217 SQ M / 2,319 SQ FT

TERRACES 19 SQ M / 208 SQ FT



Living/dining	7.40 x 7.71m	24'2" x 29'9" ft
Kitchen	4.80 x 4.77m	14'11" x 11'4" ft
Master Suite	4.38 x 4.95m	14'4" x 14'6" ft
Master Ensuite	3.86 x 1.85m	12'8" x 6'1" ft
Bedroom 2	5.29 x 3.51m	17'4" x 11'6" ft
Bedroom 3	3.38 x 3.42m	11'1" x 11'3" ft

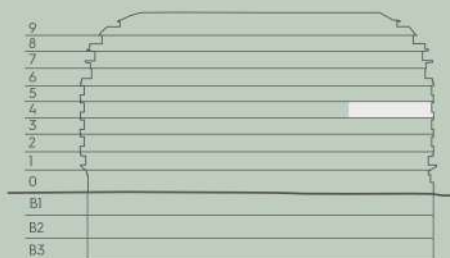

Floor Locator - Floor 4

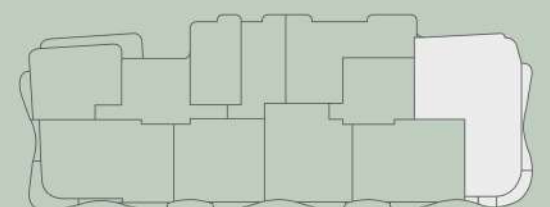

Floor plate - Floor 4

The areas and dimensions provided on these floorplans are subject to design development and are approximate and for guidance only at this stage. Further dimensions, including clear heights of windows and ceilings, balcony and terrace areas may vary in size and are subject to design development. Please speak to the sales team for details. Indicative areas are measured as gross internal areas (GIA) using the RICS code of measurement, 6th Edition.

Sunrise/sunset is a indicative guide only and is not to be used for exact positioning of the sun in relation to the apartment.

